

Conference Rooms

2F

고객이 생각하는 회의, 그 이상의 만족

Kimdaejung Convention Center provides a complete venue solution for all types of conferences and meetings.

あなたの成功ビジネスの最適な場所
成功商务的首选之地

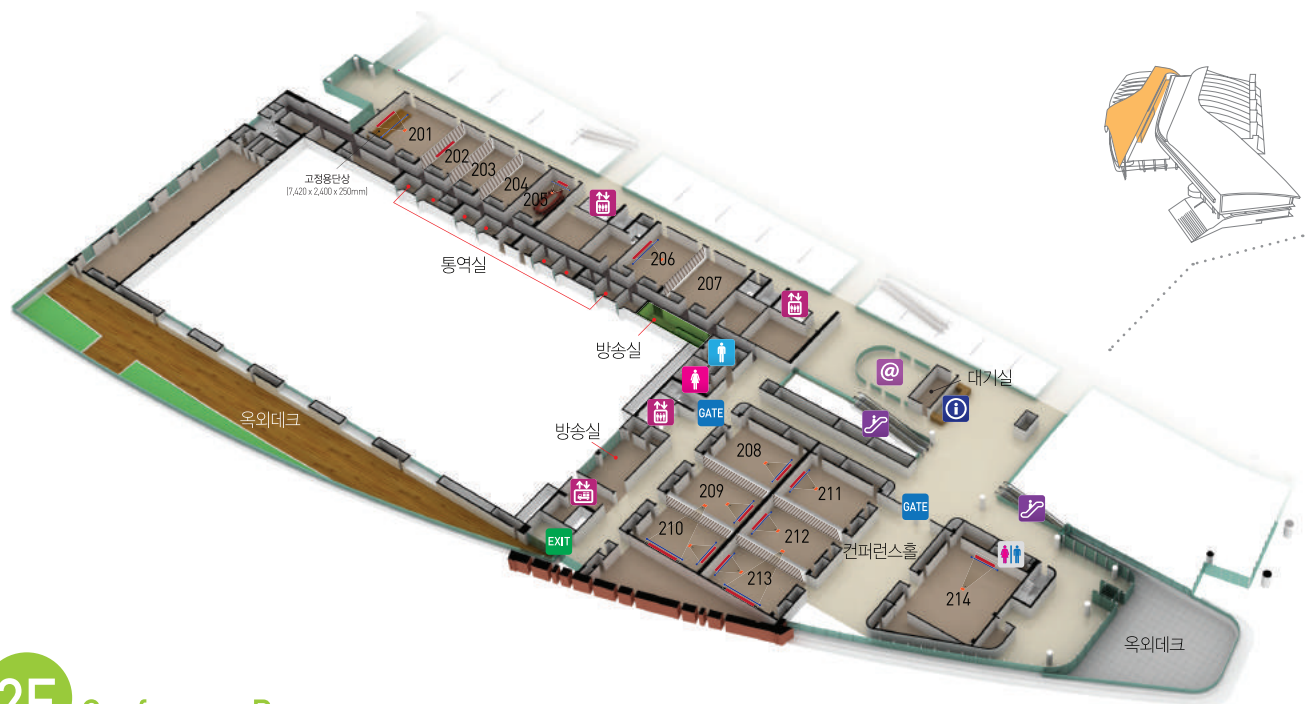

2F Conference Rooms

출입구 Gate	화장실 Restroom	남자화장실 Man Restroom	여자화장실 Woman Restroom	엘리베이터 Elevator	에스컬레이터 Escalator
비상구 Exit	인포데스크 Information Desk	인터넷라운지 Internet Lounge	홀 나눔 칸막이 Dividers	스크린 Screen	현수막 게시대 Banner Batten
조명 Lighting Batten	빔프로젝트 Beam Projector				

- 면 적 767㎡
- 수용인원 강의식(30~200석), 극장식(40~300석)
- 주요용도 회의, 세미나, 강연, 포럼, 리셉션 등
- 주요시설 컨퍼런스 홀, 대기실, 비즈니스센터, 옥외데크, 비즈니스 라운지

- Space 767㎡
- Capacity Class(30~200 seats), Theater(40~300 seats)
- The primary purposes Conference, Seminars, Talks, Forums, Receptions
- Major facilities Conference Hall, Waiting Room, Business Center, Outdoor Deck, Business Lounge



26개의 중소회의실은 규모와 형태에 맞게 분할하여 사용할 수 있습니다. 각종 세미나, 학술회의, 신제품 발표회, 간담회 등의 용도로 매우 유용하며 회의실마다 별도의 출입구가 마련되어 동선이 편리합니다.

26 Conference Rooms may be divided depending the scale and type of your events. Great for seminars, academic conferences, new product presentations, meetings, etc.

Each of conference rooms has its own separate entrance for ease of access.



• 장비현황 Equipment

[F : fixed, P : portable, C : cable, W : wireless]

Room No.	Beam Projector	Screen	Type	MIC		Batten	Room No.	Beam Projector	Screen	Type	MIC		Batten
				C	W						C	W	
201	7,000	200"	F	4	3	6m×0.9m	201+202, 206+207	7,000	200"	F	4	2	6m×0.9m
202, 203, 204	3,800	100"	P	4	1	-	202+203, 203+204	3,800	100"	F	4	2	-
205	4,500	100"	F	2	2	-	209+210, 212+213	7,000	200"	F	4	2	5m×0.9m
206	7,000	150"	F	4	2	6m×0.9m	201+202+203	7,000	200"	F	6	3	6m×0.9m
207	3,800	100"	P	3	1	-	202+203+204	3,800	100"	F	6	3	6m×0.9m
208, 209, 210, 211, 212, 213	6,000	180"	F	4	1	5m×0.9m	208+209+210, 211+212+213	7,000	200"	F	6	3	5m×0.9m
214	7,000	200"	F	4	1	5m×0.9m	201+202+203+204	7,000	200"	F	8	4	6m×0.9m

• 크기 및 수용인원 Size & Capacity

(Unit : Seat)

Room No.	Size				Capacity			
	W	L	H	(m ²)	Theater	Class	Buffet	Banquet
201, (202+203), (203+204)	12	9	4.2	108	72	48	30	50
202, 203, 204	6			54	40	30	20	20
205	6			54	14(비가변식 : 화상회의실)			
206, 207	9			81	60	40	20	30
(201+202), (206+207), (202+203+204)	18			162	144	96	70	90
(201+202+203)	24	11.8	4.2	216	200	144	100	130
(201+202+203+204)	30			270	300	200	150	200
208, 209, 210, 211, 212, 213	8.5			100	75	48	20	40
(209+210), (211+212), (212+213)	16.9			200	160	110	80	110
(208+209+210), (211+212+213)	25.5			300	240	160	110	150
214	13.9	12		167	120	80	70	80

• 임대료 Rental Rates

(Unit : 1,000 won, VAT excluded)

Room No.	Morning(A)	Afternoon(B)	Evening(C)	M-A(D)	A-E(E)	M-E(F)	Extra Hours
	9~12	13~17	18~21	9~17	13~21	9~21	
202, 203, 204, 205	126	151	107	240	265	404	40
206, 207	189	226	161	360	397	605	60
201, (202+203), (203+204)	252	302	214	480	530	808	80
(201+202), (202+203+204), (206+207)	378	454	322	721	796	1,213	121
(201+202+203)	504	605	430	961	1,061	1,618	161
(201+202+203+204)	631	757	537	1,202	1,328	2,025	202
208, 209, 210, 211, 212, 213	210	252	178	400	442	674	67
(208+209), (209+210), (211+212), (212+213)	420	504	358	801	885	1,349	134
(208+209+210), (211+212+213)	631	757	537	1,202	1,328	2,025	202
214	351	421	299	669	739	1,127	112

Conference Rooms

3F

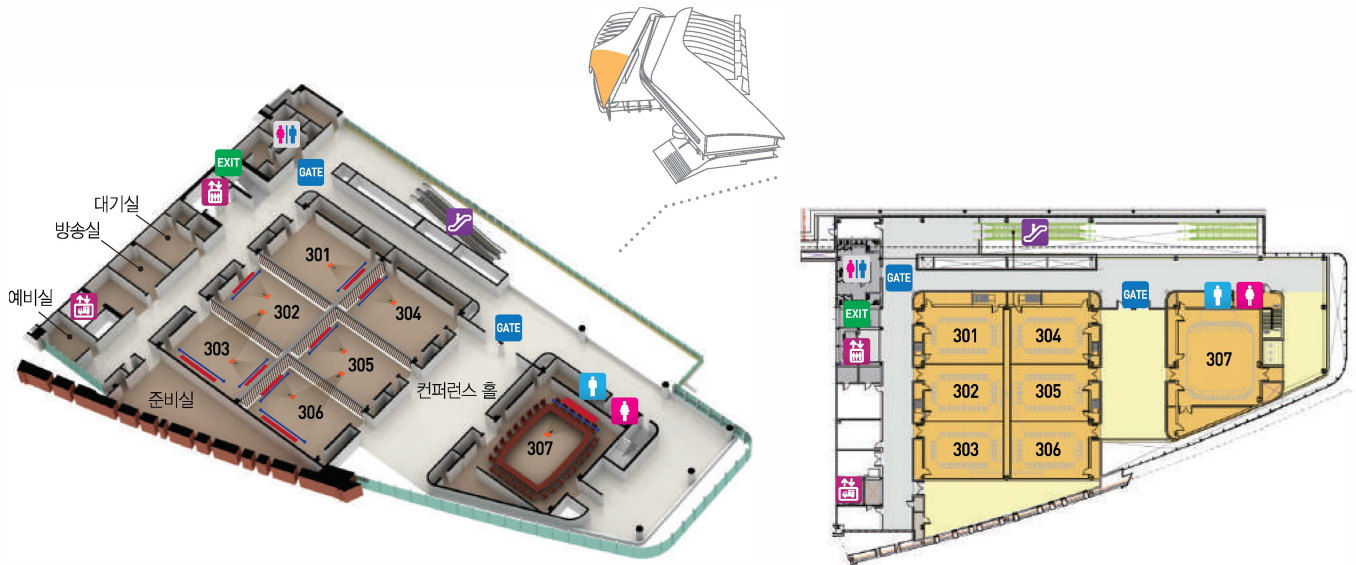

3F Conference Rooms

출입구 Gate	화장실 Restroom	남자화장실 Man Restroom	여자화장실 Woman Restroom	에스컬레이터 Escalator	엘리베이터 Elevator
홀 나눔 칸막이 Dividers	스크린 Screen	현수막 게시대 Banner Batten	조명 Lighting Batten	빔프로젝트 Beam Projector	비상구 Exit

- 면 적 767㎡
- 수용인원 강의식(48~300석), 극장식(75~450석)
- 주요용도 회의, 세미나, 강연, 포럼, 리셉션 등
- 주요시설 컨퍼런스 홀, 대기실, 비즈니스센터, 옥외데크, 비즈니스 라운지
- Space 767㎡
- Capacity Class(48~300 seats), Theater(75~450 seats)
- The primary purposes Conference, Seminars, Talks, Forums, Receptions
- Major facilities Conference Hall, Waiting Room, Business Center, Outdoor Deck, Business Lounge

장비현황 Equipment

(F : fixed, P : portable, C : cable, W : wireless)

Room No.	Beam Projector	Screen	Type	MIC		Batten
				C	W	
301, 302, 303, 304, 305, 306	6,000	180"	F	2	1	5m×0.9m
307	8,600	200"	F	3	1	5m×0.9m
302+303, 305+306	8,600	200"	F	5	2	5m×0.9m
301+302+303, 304+305+306	8,600	200"	F	6	3	5m×0.9m
301+302+303+304+305+306	8,600×2ea	200"×2ea	F	12	3	5m×0.9m

크기 및 수용인원 Size & Capacity

(Unit : Seat)

Room No.	Size				Capacity			
	W	L	H	(㎡)	Theater	Class	Buffet	Banquet
301, 302, 303, 304, 305, 306	8.5	11.8	4.2	100	75	48	20	40
[301+302], [302+303], [304+305], [305+306]	16.9			200	160	110	80	110
[301+302+303], [304+305+306]	25.5			300	240	160	110	150
307	13.9	12		167	28(비가변식)			
301+302+303+304+305+306	25.5	23		587	450	350	240	300

임대료 Rental Rates

(Unit : 1,000 won, VAT excluded)

Room No.	Morning(A)	Afternoon(B)	Evening(C)	M~	A~	M~E(F)	Extra
	9~12	13~17	18~21	9~	13~	9~21	Hours
301, 302, 303, 304, 305, 306	210	252	178	400	442	674	67
[301+302], [302+303], [304+305], [305+306]	420	504	358	801	885	1,349	134
[301+302+303], [304+305+306]	631	757	537	1,202	1,328	2,025	202
307	351	421	299	669	739	1,127	112
[301+302+303+304+305+306]	1,262	1,514	1,075	2,404	2,656	4,050	405

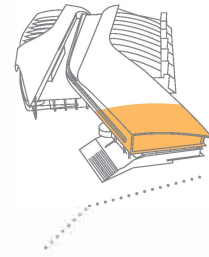

3F Conference Rooms - 컨벤션동

출입구 Gate	화장실 Restroom	구내전화 Telephone	정수기 Water Purifier	에스컬레이터 Escalator	엘리베이터 Elevator
홀 나눔 칸막이 Dividers	스크린 Screen	현수막 게시대 Banner Batten	조명 Lighting Batten	빔프로젝트 Beam Projector	주최자사무실 Organizer's Office

- 위 치 컨벤션동 3층
- 면 적 519㎡
- 수용인원 강의식(40~170석), 극장식(72~230석)
- 주요용도 회의, 세미나, 강연, 포럼, 리셉션 등
- 주요시설 주최자사무실, 준비실, 방송실, VIP실, 휴게라운지, 컨퍼런스홀

- Location 3F of Convention Building
- Space 519㎡
- Capacity Class(40~170 seats), Theater(72~230 seats)
- The primary purposes Conference, Seminars, Talks, Forums, Receptions
- Major facilities Organizer's office, Preparation room, Boardrooms, Recess Lounge, VIP room, Conference Hall

장비현황 Equipment

(F : fixed, P : portable, C : cable, W : wireless)

Room No.	Beam Projector	Screen	Type	MIC		Batten
				C	W	
C308, C309, C310, C311, C312	6,000	200"	F	2	1	5m×0.9m
C308+C309, C311+C312	6,000	200"	F	4	2	5m×0.9m

크기 및 수용인원 Size & Capacity

(Unit : Seat)

Room No.	Size				Capacity			
	W	L	H	(㎡)	Theater	Class	Buffet	Banquet
C308, C309, C310	9.5	12.1	4.5	115	72	50	20	50
C311, C312	9.4	9.2		87	72	40	20	40
[C308+C309], [C309+C310]	19	12.1		230	150	100	80	100
[C311+C312]		9.2		174	144	96	60	80
[C308+C309+C310]	28.5	12.1		345	230	170	130	180

임대료 Rental Rates

(Unit : 1,000 won, VAT excluded)

Room No.	Morning(A)	Afternoon(B)	Evening(C)	M-A(D)	A-E(E)	M-E(F)	Extra Hours
	9~12	13~17	18~21	9~17	13~21	9~21	
C308, C309, C310	241	289	205	460	508	774	77
C311, C312	182	219	155	348	384	585	58
[C308+C309], [C309+C310]	483	580	412	921	1,017	1,551	155
[C311+C312]	366	439	311	697	770	1,174	117
[C308+C309+C310]	725	870	618	1,382	1,527	2,328	232